

滚子从动件

分离型
带内圈
带侧板

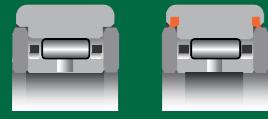

NAST..ZZ

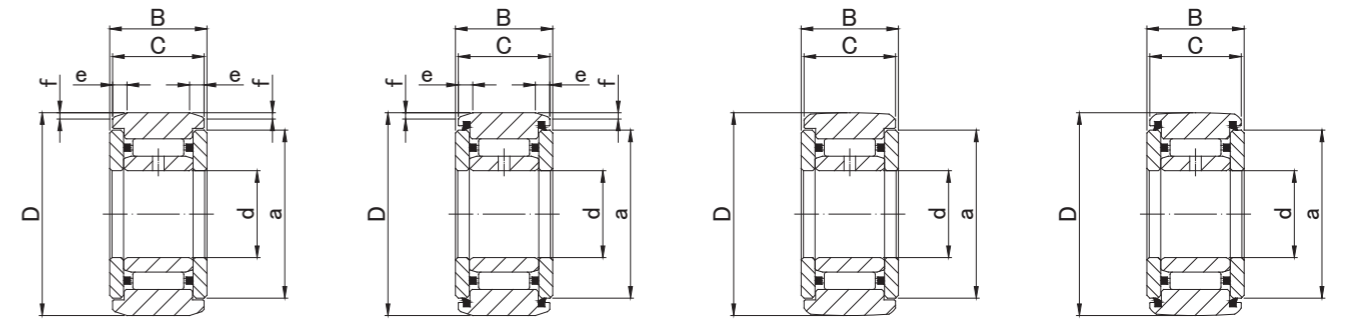

NAST..ZZ

NAST..ZZUU

NAST..ZZR

NAST..ZZUUR

NAST..ZZ 类型

预包装润滑脂

轴直径 (mm)	类型代号				尺寸 (mm)								基本额定动负荷 Cr N	基本额定静负荷 Cor N	轨道载荷能力		允许转速 * rpm	质量 g (大约)
	圆筒外圈		球面外圈 (R500)		d	D	B	C	a	e	f	圆筒外圈 N			球面外圈 N			
	无密封圈	带密封圈	无密封圈	带密封圈														
6	NAST 6ZZ	NAST 6ZZUU	NAST 6ZZR	NAST 6ZZUUR	6 ⁰ _{-0.008}	19	14	13.8	14		2.5	0.8	4 120	4 550	3 530	1 370	20 000	24.5
8	NAST 8ZZ	NAST 8ZZUU	NAST 8ZZR	NAST 8ZZUUR	8 ⁰ _{-0.008}	24	14	13.8	17.5		2.5	0.8	5 680	5 890	4 510	1 860	17 000	39
10	NAST10ZZ	NAST10ZZUU	NAST10ZZR	NAST10ZZUUR	10 ⁰ _{-0.008}	30	16	15.8	23.5		2.5	0.8	9 700	9 670	6 860	2 450	15 000	65
12	NAST12ZZ	NAST12ZZUU	NAST12ZZR	NAST12ZZUUR	12 ⁰ _{-0.008}	32	16	15.8	25.5		2.5	0.8	10 400	10 900	7 350	2 740	13 000	75
15	NAST15ZZ	NAST15ZZUU	NAST15ZZR	NAST15ZZUUR	15 ⁰ _{-0.008}	35	16	15.8	29		2.5	0.8	12 300	14 300	8 040	3 140	10 000	83
17	NAST17ZZ	NAST17ZZUU	NAST17ZZR	NAST17ZZUUR	17 ⁰ _{-0.008}	40	20	19.8	32.5		3	1	17 400	20 900	11 800	3 720	9 500	135
20	NAST20ZZ	NAST20ZZUU	NAST20ZZR	NAST20ZZUUR	20 ⁰ _{-0.010}	47	20	19.8	38		3	1	19 200	24 500	13 800	4 610	8 500	195
25	NAST25ZZ	NAST25ZZUU	NAST25ZZR	NAST25ZZUUR	25 ⁰ _{-0.010}	52	20	19.8	43		3	1	20 700	28 400	15 300	5 290	7 000	225
30	NAST30ZZ	NAST30ZZUU	NAST30ZZR	NAST30ZZUUR	30 ⁰ _{-0.010}	62	25	24.8	50.5		4	1.2	30 300	45 400	22 100	6 660	5 500	400
35	NAST35ZZ	NAST35ZZUU	NAST35ZZR	NAST35ZZUUR	35 ⁰ _{-0.012}	72	25	24.8	53.5		4	1.2	32 200	50 600	25 700	8 130	5 000	550
40	NAST40ZZ	NAST40ZZUU	NAST40ZZR	NAST40ZZUUR	40 ⁰ _{-0.012}	80	26	25.8	61.5		4	1.2	35 700	61 100	30 300	9 310	4 000	710
45	NAST45ZZ	NAST45ZZUU	NAST45ZZR	NAST45ZZUUR	45 ⁰ _{-0.012}	85	26	25.8	66.5		4	1.2	37 100	66 400	31 100	10 100	4 000	760
50	NAST50ZZ	NAST50ZZUU	NAST50ZZR	NAST50ZZUUR	50 ⁰ _{-0.012}	90	26	25.8	76		4	1.2	38 700	71 800	34 000	11 000	3 500	830

* 无密封圈，适合润滑脂润滑。如果是油润滑，最大允许值可到达该数值的 130%。若为密封型，数值为该数值的 70%。

类型	圆筒外圈	球面外圈
NAST6,NAST8,NAST10	0/-9	0/-50
NAST12,NAST15,NAST17,NAST20	0/-11	0/-50
NAST25,NAST30,NAST35,NAST40	0/-13	0/-50
NAST45,NAST50	0/-15	0/-50