

CAM FOLLOWERS SCREWDRIVER SLOT HEAD

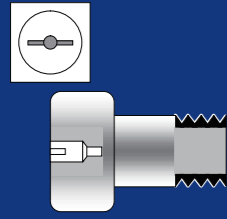

CF



CF.V

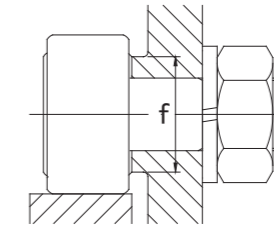
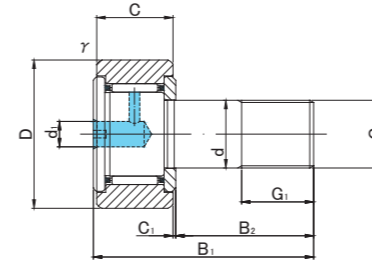

CF TYPE

Prepacked Grease

Stud diameter (mm)	h7 tolerance	Designation				Dimensions (mm)												Basic dynamic load rating	Basic static load rating	Largest permissible load	Limiting speed *	Track load capacity		Max tightening torque	Mass
		Cylindrical outer ring		Crowned outer ring R250(CF5) R500(CF6 ~ CF10-1)		D	C	d	G	G1	B1	B2	C1	d1	r _s min	f min	Cr N					Cor N	N		
5	0 -0.012	CF 5	CF 5UU	CF 5R	CF 5UUR	13	9	5	M5x0.8	7.5	23	13	0.5	3.1	0.3	9.7	3 140	2 770	1 420	29 000	2 250	530	2	10.5	
		CF 5V	CF 5VUU	CF 5VR	CF 5VUUR												5 100	5 500	1 420	11 600					
6	0 -0.012	CF 6	CF 6UU	CF 6R	CF 6UUR	16	11	6	M6x1	8	28	16	0.6	4	0.3	11	3 630	3 630	2 110	25 000	3 430	1 080	3	18.5	
		CF 6V	CF 6VUU	CF 6VR	CF 6VUUR												6 960	8 530	2 110	12 000					
8	0 -0.015	CF 8	CF 8UU	CF 8R	CF 8UUR	19	11	8	M8x1.25	10	32	20	0.6	4	0.3	13	4 310	4 710	4 710	20 000	4 020	1 370	8	28.5	
		CF 8V	CF 8VUU	CF 8VR	CF 8VUUR												8 130	11 170	4 710	9 000					
10	0 -0.015	CF10	CF10UU	CF10R	CF10UUR	22	12	10	M10x1.25	12	36	23	0.6	4	0.3	15	5 390	6 860	6 860	17 000	4 700	1 670	15	45	
		CF10V	CF10VUU	CF10VR	CF10VUUR												9 510	14 500	7 450	7 500					
10	0 -0.015	CF10-1	CF10-1UU	CF10-1R	CF10-1UUR	26	12	10	M10x1.25	12	36	23	0.6	4	0.3	15	5 390	6 860	6 860	17 000	5 490	2 060	15	60	
		CF10-1V	CF10-1VUU	CF10-1VR	CF10-1VUUR												9 510	14 500	7 450	7 500					

* Without seals, suitable for grease lubrication. In case of oil lubrication, up to 130% of this value shall be permissible, and 70% of this value shall apply for types with seals.

OUTER RINGS TOLERANCE

TYPE	Cylindrical outer ring	Crowned outer ring
CF5,CF6	0/-8	0/-50
CF8,CF10,CF10-1	0/-9	0/-50

ACCESSORIES

TYPE	RESIN PLUG	NUT
CF5	—	Attached
CF6/CF8/CF10/CF10-1	φ 4 Attached	Attached