

CAM FOLLOWERS

HEXAGON SOCKET ON STUD HEAD

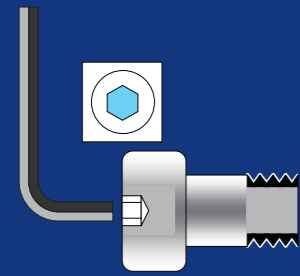

CF..A



CF..VA

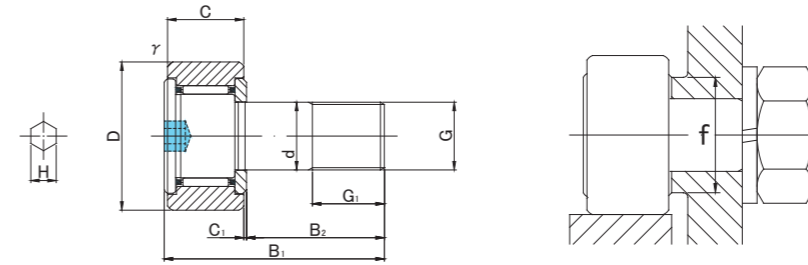

CF..A TYPE

Prepacked Grease

Stud diameter (mm)	h7 tolerance	Designation				Dimensions (mm)								Basic dynamic load rating	Basic static load rating	Largest permissible load	Limiting speed *	Track load capacity		Max tightening torque	Mass			
		Cylindrical outer ring		Crowned outer ring R250(≤CF5) R500(CF6~CF10-1)		D	C	d	G	G1	B1	B2	C1					H	r _s min			f min	Cr N	Cor N
3	0 -0.010	CF 3A	CF 3UUA	CF 3RA	CF 3UURA	10	7	3	M3×0.5	5	17	9	0.5	2	0.2	6.8	1 470	1 180	360	47 000	1 370	370	0.4	4.5
		CF 3VA	CF 3VUUA	CF 3VRA	CF 3VUURA												2 800	2 500	360	18 800				
4	0 -0.012	CF 4A	CF 4UUA	CF 4RA	CF 4UURA	12	8	4	M4×0.7	6	20	11	0.5	2.5	0.3	8.6	2 060	2 050	780	37 000	1 760	470	1	7.5
		CF 4VA	CF 4VUUA	CF 4VRA	CF 4VUURA												4 000	4 300	780	14 800				
5	0 -0.012	CF 5A	CF 5UUA	CF 5RA	CF 5UURA	13	9	5	M5×0.8	7.5	23	13	0.5	3	0.3	9.7	3 140	2 770	1 420	29 000	2 250	530	2	10.5
		CF 5VA	CF 5VUUA	CF 5VRA	CF 5VUURA												5 100	5 500	1 420	11 600				
6	0 -0.012	CF 6A	CF 6UUA	CF 6RA	CF 6UURA	16	11	6	M6×1	8	28	16	0.6	3	0.3	11	3 630	3 630	2 110	25 000	3 430	1 080	3	18.5
		CF 6VA	CF 6VUUA	CF 6VRA	CF 6VUURA												6 960	8 530	2 110	12 000				
8	0 -0.015	CF 8A	CF 8UUA	CF 8RA	CF 8UURA	19	11	8	M8×1.25	10	32	20	0.6	4	0.3	13	4 310	4 710	4 710	20 000	4 020	1 370	8	28.5
		CF 8VA	CF 8VUUA	CF 8VRA	CF 8VUURA												8 130	11 170	4 710	9 000				
10	0 -0.015	CF10A	CF10UUA	CF10RA	CF10UURA	22	12	10	M10×1.25	12	36	23	0.6	5	0.3	15	5 390	6 860	6 860	17 000	4 700	1 670	15	45
		CF10VA	CF10VUUA	CF10VRA	CF10VUURA												9 510	14 500	7 450	7 500				
10	0 -0.015	CF10-1A	CF10-1UUA	CF10-1RA	CF10-1UURA	26	12	10	M10×1.25	12	36	23	0.6	5	0.3	15	5 390	6 860	6 860	17 000	5 490	2 060	15	60
		CF10-1VA	CF10-1VUUA	CF10-1VRA	CF10-1VUURA												9 510	14 500	7 450	7 500				

* Without seals, suitable for grease lubrication. In case of oil lubrication, up to 130% of this value shall be permissible, and 70% of this value shall apply for types with seals.

OUTER RINGS TOLERANCE (μm)

TYPE	Cylindrical outer ring	Crowned outer ring
CF3,CF4,CF5,CF6	0/-8	0/-50
CF8,CF10,CF10-1	0/-9	0/-50

ACCESSORIES

TYPE	Image
CF3/CF4/CF5/CF6/CF8/CF10/CF10-1	 NUT Attached