

CAM FOLLOWERS

HEXAGON SOCKET ON THREAD SIDE
SCREWDRIVER SLOT HEAD

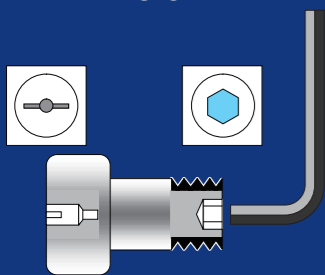

CF..B



CF..VB

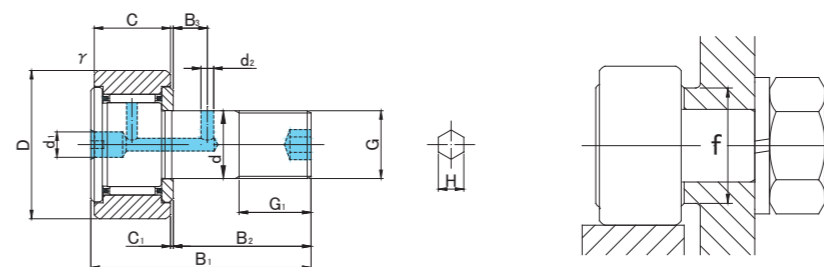

CF..B TYPE

Prepacked Grease

Stud diameter (mm)	h7 tolerance	Designation				Dimensions (mm)															Basic dynamic load rating	Basic static load rating	Largest permissible load	Limiting speed *	Track load capacity		Max tightening torque	Mass					
		Cylindrical outer ring		Crowned outer ring R500(CF12 ~ CF18) R1000(CF20 ≤)		D	C	d	G	G1	B1	B2	B3	C1	d1	d2	H	rs min	f min	Cr N					Cor N	N			rpm	Cylindrical outer ring N	Crowned outer ring N	N·m	g (approx)
		Without seals	With seals	Without seals	With seals																												
12	0 -0.018	CF12B	CF12UUB	CF12RB	CF12UURB	30	14	12	M12×1.5	13	40	25	6	0.6	6	3	6	0.6	20	7 940	9 800	9 800	14 000	7 060	2 450	22	95						
		CF12VB	CF12VUUB	CF12VRB	CF12VUURB															13 430	19 700	11 270	6 000										
12	0 -0.018	CF12-1B	CF12-1UUB	CF12-1RB	CF12-1UURB	32	14	12	M12×1.5	13	40	25	6	0.6	6	3	6	0.6	20	7 940	9 800	9 800	14 000	7 450	2 740	22	105						
		CF12-1VB	CF12-1VUUB	CF12-1VRB	CF12-1VUURB															13 430	19 700	11 270	6 000										
16	0 -0.018	CF16B	CF16UUB	CF16RB	CF16UURB	35	18	16	M16×1.5	17	52	32.5	8	0.8	6	3	6	0.6	24	12 050	18 330	18 330	10 000	11 200	3 140	58	170						
		CF16VB	CF16VUUB	CF16VRB	CF16VUURB															20 680	37 630	19 800	4 500										
18	0 -0.018	CF18B	CF18UUB	CF18RB	CF18UURB	40	20	18	M18×1.5	19	58	36.5	8	0.8	6	3	6	1	26	14 700	25 200	25 200	8 500	14 400	3 720	87	250						
		CF18VB	CF18VUUB	CF18VRB	CF18VUURB															25 280	51 350	26 560	3 500										
20	0 -0.021	CF20B	CF20UUB	CF20RB	CF20UURB	52	24	20	M20×1.5	21	66	40.5	9	0.8	8	4	8	1	36	20 680	34 600	32 140	7 000	23 200	8 230	120	460						
		CF20VB	CF20VUUB	CF20VRB	CF20VUURB															33 120	64 480	32 140	3 500										
20	0 -0.021	CF20-1B	CF20-1UUB	CF20-1RB	CF20-1UURB	47	24	20	M20×1.5	21	66	40.5	9	0.8	8	4	8	1	36	20 680	34 600	32 140	7 000	21 000	7 150	120	385						
		CF20-1VB	CF20-1VUUB	CF20-1VRB	CF20-1VUURB															33 120	64 480	32 140	3 500										
24	0 -0.021	CF24B	CF24UUB	CF24RB	CF24UURB	62	29	24	M24×1.5	25	80	49.5	11	0.8	8	4	8	1	40	30 480	52 630	49 500	6 500	34 200	10 500	220	815						
		CF24VB	CF24VUUB	CF24VRB	CF24VUURB															46 550	92 020	49 500	3 000										
24	0 -0.021	CF24-1B	CF24-1UUB	CF24-1RB	CF24-1UURB	72	29	24	M24×1.5	25	80	49.5	11	0.8	8	4	8	1	40	30 480	52 630	49 500	6 500	39 800	12 900	220	1 140						
		CF24-1VB	CF24-1VUUB	CF24-1VRB	CF24-1VUURB															46 550	92 020	49 500	3 000										
30	0 -0.021	CF30B	CF30UUB	CF30RB	CF30UURB	80	35	30	M30×1.5	32	100	63	15	1	8	4	8	1	46	45 370	85 060	73 700	5 000	52 600	14 900	450	1 870						
		CF30VB	CF30VUUB	CF30VRB	CF30VUURB															67 620	144 060	73 700	2 200										
30	0 -0.021	CF30-1B	CF30-1UUB	CF30-1RB	CF30-1UURB	85	35	30	M30×1.5	32	100	63	15	1	8	4	8	1	46	45 370	85 060	73 700	5 000	56 000	16 100	450	2 030						
		CF30-1VB	CF30-1VUUB	CF30-1VRB	CF30-1VUURB															67 620	144 060	73 700	2 200										
30	0 -0.021	CF30-2B	CF30-2UUB	CF30-2RB	CF30-2UURB	90	35	30	M30×1.5	32	100	63	15	1	8	4	8	1	46	45 370	85 060	73 700	5 000	59 300	17 300	450	2 220						
		CF30-2VB	CF30-2VUUB	CF30-2VRB	CF30-2VUURB															67 620	144 060	73 700	2 200										

* Without seals, suitable for grease lubrication. In case of oil lubrication, up to 130% of this value shall be permissible, and 70% of this value shall apply for types with seals.

OUTER RINGS TOLERANCE (μm)

TYPE	Cylindrical outer ring	Crowned outer ring
CF12	0/-9	0/-50
CF12-1,CF16,CF18,CF20-1	0/-11	0/-50
CF20,CF24,CF24-1,CF30	0/-13	0/-50
CF30-1,CF30-2	0/-15	0/-50

ACCESSORIES

TYPE	STOP PLUG	RESIN PLUG	NUT
CF12/CF12-1/CF16/CF18	φ 6 Attached	φ 6 Attached	Attached
CF20/CF20-1/CF24/CF24-1/CF30/CF30-1/CF30-2	φ 8 Attached	φ 8 Attached	Attached