

# CAM FOLLOWERS

**SOLID ECCENTRIC TYPE**  
HEXAGON SOCKET ON THREAD SIDE  
SCREWDRIVER SLOT HEAD

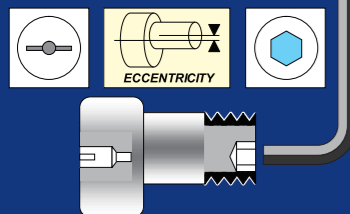

CFH..B



CFH..VB

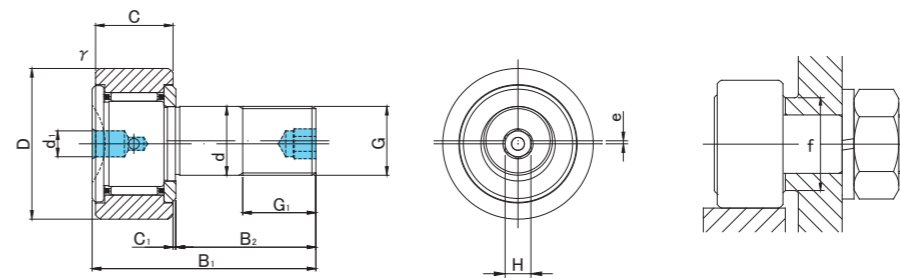

## CFH..B TYPE

Prepacked Grease

Stud diameter (mm)	h7 tolerance	Designation				Dimensions (mm)												Basic dynamic load rating Cr N	Basic static load rating Cor N	Largest permissible load N	Limiting speed * rpm	Track load capacity		Max tightening torque N·m	Mass g (approx)	
		Cylindrical outer ring		Crowned outer ring R500(CF12 ~ CF18) R1000(CF20 ≤)		D	C	d	G	G1	B1	B2	C1	d1	H	rs min	e					f min	Cylindrical outer ring N			Crowned outer ring N
		Without seals	With seals	Without seals	With seals																					
12	0 -0.018	CFH12B	CFH12UUB	CFH12RB	CFH12UURB	30	14	12	M12×1.5	13	40	25	0.6	6	6	0.6	0.4	20	7 940	9 800	9 800	14 000	7 060	2 450	22	95
		CFH12VB	CFH12VUUB	CFH12VRB	CFH12VUURB														13 430	19 700	11 270	6 000				
12	0 -0.018	CFH12-1B	CFH12-1UUB	CFH12-1RB	CFH12-1UURB	32	14	12	M12×1.5	13	40	25	0.6	6	6	0.6	0.4	20	7 940	9 800	9 800	14 000	7 450	2 740	22	105
		CFH12-1VB	CFH12-1VUUB	CFH12-1VRB	CFH12-1VUURB														13 430	19 700	11 270	6 000				
16	0 -0.018	CFH16B	CFH16UUB	CFH16RB	CFH16UURB	35	18	16	M16×1.5	17	52	32.5	0.8	6	6	0.6	0.5	24	12 050	18 330	18 330	10 000	11 200	3 140	58	170
		CFH16VB	CFH16VUUB	CFH16VRB	CFH16VUURB														20 680	37 630	19 800	4 500				
18	0 -0.018	CFH18B	CFH18UUB	CFH18RB	CFH18UURB	40	20	18	M18×1.5	19	58	36.5	0.8	6	6	1	0.6	26	14 700	25 200	25 200	8 500	14 400	3 720	87	250
		CFH18VB	CFH18VUUB	CFH18VRB	CFH18VUURB														25 280	51 350	26 560	3 500				
20	0 -0.021	CFH20B	CFH20UUB	CFH20RB	CFH20UURB	52	24	20	M20×1.5	21	66	40.5	0.8	8	8	1	0.7	36	20 680	34 600	32 140	7 000	23 200	8 230	120	460
		CFH20VB	CFH20VUUB	CFH20VRB	CFH20VUURB														33 120	64 480	32 140	3 500				
20	0 -0.021	CFH20-1B	CFH20-1UUB	CFH20-1RB	CFH20-1UURB	47	24	20	M20×1.5	21	66	40.5	0.8	8	8	1	0.7	36	20 680	34 600	32 140	7 000	21 000	7 150	120	385
		CFH20-1VB	CFH20-1VUUB	CFH20-1VRB	CFH20-1VUURB														33 120	64 480	32 140	3 500				
24	0 -0.021	CFH24B	CFH24UUB	CFH24RB	CFH24UURB	62	29	24	M24×1.5	25	80	49.5	0.8	8	8	1	0.8	40	30 480	52 630	49 500	6 500	34 200	10 500	220	815
		CFH24VB	CFH24VUUB	CFH24VRB	CFH24VUURB														46 550	92 020	49 500	3 000				
24	0 -0.021	CFH24-1B	CFH24-1UUB	CFH24-1RB	CFH24-1UURB	72	29	24	M24×1.5	25	80	49.5	0.8	8	8	1	0.8	40	30 480	52 630	49 500	6 500	39 800	12 900	220	1 140
		CFH24-1VB	CFH24-1VUUB	CFH24-1VRB	CFH24-1VUURB														46 550	92 020	49 500	3 000				
30	0 -0.021	CFH30B	CFH30UUB	CFH30RB	CFH30UURB	80	35	30	M30×1.5	32	100	63	1	8	8	1	1	46	45 370	85 060	73 700	5 000	52 600	14 900	450	1 870
		CFH30VB	CFH30VUUB	CFH30VRB	CFH30VUURB														67 620	144 060	73 700	2 200				
30	0 -0.021	CFH30-1B	CFH30-1UUB	CFH30-1RB	CFH30-1UURB	85	35	30	M30×1.5	32	100	63	1	8	8	1	1	46	45 370	85 060	73 700	5 000	56 000	16 100	450	2 030
		CFH30-1VB	CFH30-1VUUB	CFH30-1VRB	CFH30-1VUURB														67 620	144 060	73 700	2 200				
30	0 -0.021	CFH30-2B	CFH30-2UUB	CFH30-2RB	CFH30-2UURB	90	35	30	M30×1.5	32	100	63	1	8	8	1	1	46	45 370	85 060	73 700	5 000	59 300	17 300	450	2 220
		CFH30-2VB	CFH30-2VUUB	CFH30-2VRB	CFH30-2VUURB														67 620	144 060	73 700	2 200				

\* Without seals, suitable for grease lubrication. In case of oil lubrication, up to 130% of this value shall be permissible, and 70% of this value shall apply for types with seals.

### OUTER RINGS TOLERANCE (μm)

TYPE	Cylindrical outer ring	Crowned outer ring
CF12	0/-9	0/-50
CF12-1,CF16,CF18,CF20-1	0/-11	0/-50
CF20,CF24,CF24-1,CF30	0/-13	0/-50
CF30-1,CF30-2	0/-15	0/-50

### ACCESSORIES

TYPE	STOP PLUG	RESIN PLUG	NUT
CF12/CF12-1/CF16/CF18	φ 6 Attached	φ 6 Attached	Attached
CF20/CF20-1/CF24/CF24-1/CF30/CF30-2	φ 8 Attached	φ 8 Attached	Attached