

CFH..M

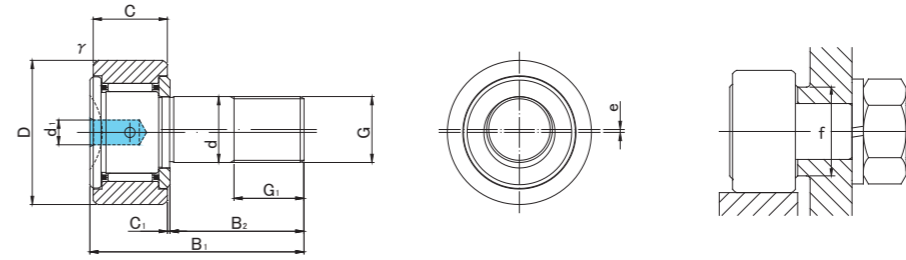

CFH..VM



CFH..M TYPE

Prepacked Grease

Stud diameter (mm)	Designation				Dimensions (mm)												Basic dynamic load rating	Basic static load rating	Largest permissible load	Limiting speed *	Track load capacity		Max tightening torque	Mass	
	Cylindrical outer ring		Crowned outer ring R500		D	C	d	G	G1	B1	B2	C1	d1	r _s min	e	f min					Cr N	Cor N			N
6	0 -0.012	CFH 6M	CFH 6MUU	CFH 6MR													CFH 6MUUR	16	11	6			M6×1	8	
		CFH 6VM	CFH 6VMUU	CFH 6VMR	CFH 6VMUUR	6 400	7 840	2 110	12 000																
8	0 -0.015	CFH 8M	CFH 8MUU	CFH 8MR	CFH 8MUUR	19	11	8	M8×1.25	10	32	20	0.6	4	0.3	0.25	13	3 960	4 330	4 710	20 000	4 020	1 370	8	28.5
		CFH 8VM	CFH 8VMUU	CFH 8VMR	CFH 8VMUUR													7 470	10 270	4 710	9 000				
10	0 -0.015	CFH10M	CFH10MUU	CFH10MR	CFH10MUUR	22	12	10	M10×1.25	12	36	23	0.6	4	0.3	0.3	15	4 950	6 310	6 860	17 000	4 700	1 670	15	45
		CFH10VM	CFH10VMUU	CFH10VMR	CFH10VMUUR													8 740	13 340	7 450	7 500				
10	0 -0.015	CFH10-1M	CFH10-1MUU	CFH10-1MR	CFH10-1MUUR	26	12	10	M10×1.25	12	36	23	0.6	4	0.3	0.3	15	4 950	6 310	6 860	17 000	5 490	2 060	15	60
		CFH10-1VM	CFH10-1VMUU	CFH10-1VMR	CFH10-1VMUUR													8 740	13 340	7 450	7 500				

* Without seals, suitable for grease lubrication. In case of oil lubrication, up to 130% of this value shall be permissible, and 70% of this value shall apply for types with seals.

TYPE	Cylindrical outer ring	Crowned outer ring
CF6M	0/-8	0/-50
CF8M,CF10M,CF10-1M	0/-9	0/-50

TYPE	RESIN PLUG	STAINLESS NUT
CF6M/CF8M/CF10M/CF10-1M	φ 4 Attached	Attached